

Glamour

GLA.2



Art. GLA.1
Art. GLA.2
Art. GLA.3

Descrizione: / Description:

Applique media a parete in gres ceramico smaltato bianco con riflettore in metacrilato colore bianco-latte.

/ Medium wall lamp made of white glazed ceramic with white-milk shiny methacrylate reflector.

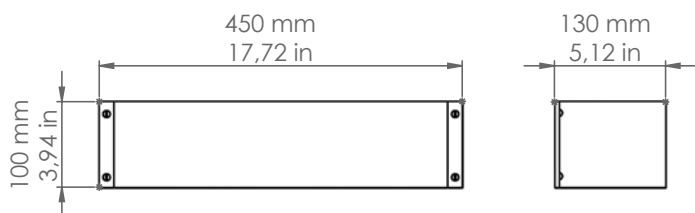

GLA.2

DATI TECNICI: / TECHNICAL DATA:

CE IP40 

SORGENTE LUMINOSA: / LIGHT SOURCE:

1x20W LED
230V - 50Hz
R7S 118mm

LAMPADINA NON INCLUSA

/ LIGHT BULB NOT INCLUDED

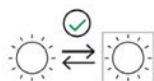

Sorgente luminosa sostituibile dall'utente finale
/ Replaceable light source by an end-user

MATERIALE: Gres ceramico e metacrilato
/ MATERIAL: Glazed ceramic and methacrylate

VOLUME [M³]: 0,06

PESO LORDO [Kg]: 3,780
/ GROSS WEIGHT [Kg]:

FINITURE: Gres ceramico smaltato bianco
e metacrilato colore bianco-latte
/ FINISHES: White glazed ceramic and
white-milk shiny methacrylate